



CLIC

CLIC

Apparecchio da incasso a parete per illuminazione di interni ed esterni costituito da:

- Struttura in alluminio pressofuso verniciato
- Art. 6012-6014 anello in acciaio inox AISI 316L
- Diffusore in vetro temperato
- Guarnizione in silicone
- Viti di chiusura in acciaio inox
- Cassaforma in tecnopolimero
- Verniciatura in polveri poliestere ad elevata resistenza ai raggi ultravioletti e alla corrosione

Indoor and outdoor recessed wall luminaire constructed of:

- Painted die-cast aluminium structure
- Art. 6012-6014 stainless steel AISI 316L ring
- Tempered glass diffuser
- Silicon gasket
- Stainless steel screws
- Technopolymer wall holder
- Painting using high resistance to UV and corrosion polyester powders



Colori - Colours

X=9  Antracite
Anthracite

X=4  Silver

Diffusore - Diffuser

Codice-Code **00 4010**
per/for Cod. 4012

Codice-Code **00 4011**
per/for Cod. 4011/4014

Codice-Code **00 6010**
per/for Cod. 6012 - 6014

Gli apparecchi vengono forniti completi di cassaforma

The holder is enclosed with the luminaire



Incasso a parete
Recessed wall version



cod. CS 4010
Cassaforma in tecnopolimero per vano ad incasso Ø 110 mm - h 100 mm
Technopolymer holder to be recessed into the wall Ø 110 mm - h 100 mm



La cassaforma deve essere installata a filo muro
Holder must be recessed flush with the wall surface

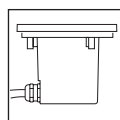

Entrata singola cavi di alimentazione con pressacavi M16 (Ø 5÷10 mm). Usare cavi flessibili. (Cavi rigidi possono compromettere la tenuta stagna IP67).
Single power supply entry cable with M16 cable glands. Use flexible cables (rigid cables may compromise IP67 rating)

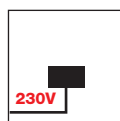

LED
Led a tensione di rete 220/240V 50/60Hz. Connessione diretta alla rete di alimentazione senza necessità di alimentatore.
LED's direct operation at 220/240V 50/60Hz. No power supply is required.



4011 - 4014



4012 - 6012 - 6014



4011

4011.66X	LED	4W	510 lm	4000 K
4011.67X	LED	4W	500 lm	3000 K

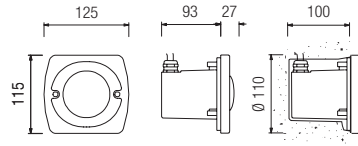

4012

4012.66X	LED	4W	510 lm	4000 K
4012.67X	LED	4W	500 lm	3000 K

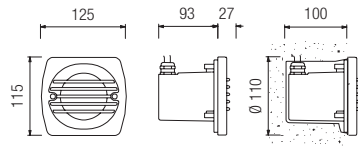

4014

4014.66X	LED	4W	510 lm	4000 K
4014.67X	LED	4W	500 lm	3000 K

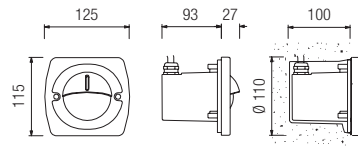

6012 INOX

6012.660	LED	4W	510 lm	4000 K
6012.670	LED	4W	500 lm	3000 K

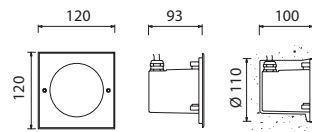

6014 INOX

6014.660	LED	4W	510 lm	4000 K
6014.670	LED	4W	500 lm	3000 K

