

PACK

Apparecchio per illuminazione di esterni e/o di interni costituito da:

- Corpo in alluminio pressofuso verniciato
- Copertura in acciaio inox AISI 316L per Cod. 1400
- Copertura in alluminio pressofuso verniciato per Cod. 1405-1408-1305-1308
- Diffusore in vetro
- Guarnizioni in silicone
- Viti di chiusura in acciaio inox
- Verniciatura in polveri poliestere ad elevata resistenza ai raggi ultravioletti e alla corrosione

Outdoor and/or indoor luminaire constructed of:

- Painted die-cast aluminium body
- Stainless steel AISI 316L cover for Cod. 1400
- Die-cast painted aluminium cover for Cod. 1405-1408-1305-1308
- Glass diffuser
- Silicon gaskets
- Stainless steel screws
- Painting using high resistance to UV and corrosion polyester powders



Colori - Colours

X=9  Antracite
Anthracite

X=4  Silver

Diffusore - Diffuser

Codice-Code 00 1400

Codice-Code 00 1300

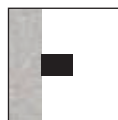

Installazione a parete
Wall mounting



Installazione a soffitto
Ceiling mounting

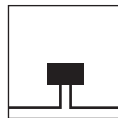

Doppia entrata cavi di alimentazione
Double power supply cables input

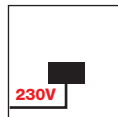

LED
Led a tensione di rete 220/240V 50/60Hz.
Connessione diretta alla rete di alimentazione
senza necessità di alimentatore.
LED's direct operation at 220/240V 50/60Hz.
No power supply is required.



IK 05





1400 - 1405

Copertura in acciaio inox AISI 316L

Stainless steel AISI 316L cover

1400.250	LED	12,9W	1500lm	4000 K
1400.260	LED	12,9W	1500lm	3000 K

Copertura in alluminio pressofuso

Die-cast aluminium cover

1405.25X	LED	12,9W	1500lm	4000 K
1405.26X	LED	12,9W	1500lm	3000 K

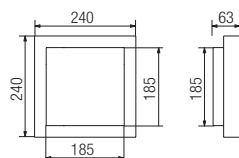

1408

Copertura in alluminio pressofuso

Die-cast aluminium cover

1408.25X	LED	12,9W	1500lm	4000 K
1408.26X	LED	12,9W	1500lm	3000 K

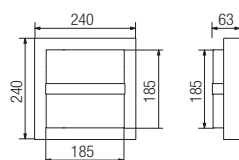

1305

Copertura in alluminio pressofuso

Die-cast aluminium cover

1305.45X	LED	12,9W	1500 lm	4000 K
1305.46X	LED	12,9W	1500 lm	3000 K

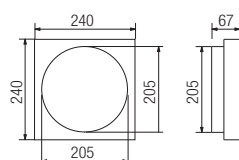

1308

Copertura in alluminio pressofuso

Die-cast aluminium cover

1308.45X	LED	12,9W	1500 lm	4000 K
1308.46X	LED	12,9W	1500 lm	3000 K

