

BLITZ

Apparecchio a sezione cilindrica a parete o a soffitto per esterni a uno o a due fasci luminosi; è disponibile in diverse dimensioni. È costituito da:

- Corpo in alluminio estruso e in alluminio pressofuso verniciato
- Diffusore in vetro temperato
- Parabola riflettente in alluminio
- Guarnizioni in silicone
- Viti di chiusura in acciaio inox
- Verniciatura in polveri poliestere ad elevata resistenza ai raggi ultravioletti e alla corrosione

One or two light beams outdoor wall or ceiling cylindrical section luminaire available in different sizes. It is constructed of:

- Extruded and die-casted aluminium body
- Tempered glass diffuser
- Aluminium reflector
- Silicon gaskets
- Stainless steel screws
- Painting using high resistance to UV and corrosion polyester powders



Colori - Colours

X=9  Anthracite
Anthracite

X=4  Silver

Diffusore - Diffuser

Codice-Code 00 9061
00 9071

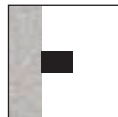

Installazione a parete
Wall mounting



Lampadina LED GU10 IP20 dimmerabile
LED GU10 IP20 dimmable bulb



Cod. 9067 - 9077
Installazione a soffitto
Ceiling mounting



Lampadina LED PAR30 IP65 dimmerabile
LED PAR30 IP65 dimmable bulb

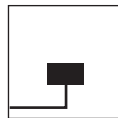

Entrata singola cavi di alimentazione
Single power supply cables input

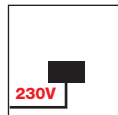

LED BLITZ Ø93 e
BLITZ Ø130 Cod. 9061 - 9064 - 9067
Led a tensione di rete 220/240V 50/60Hz.
Connessione diretta alla rete di alimentazione
senza necessità di alimentatore.
LED's direct operation at 220/240V 50/60Hz.
No power supply is required.

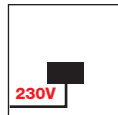

LED Cod. 9068 - 9069
L'apparecchio è fornito completo di alimentatore elettronico 220/240V 50/60Hz
posizionato all'interno dell'apparecchio.
The luminaire is supplied with a 220/240V 50/60Hz
built-in power supply



IK 07





9075 - 9076 Ø 93



Monodirezionale
Mono direction light

9075.66X	LED	4W	510 lm	4000 K
9075.67X	LED	4W	500 lm	3000 K
● 9075.05X	LED GU10	4,9W	560 lm	4000 K
● 9075.06X	LED GU10	4,9W	560 lm	3000 K



Bidirezionale
Double direction light

9076.66X	LED	2x4W	2x510 lm	4000 K
9076.67X	LED	2x4W	2x500 lm	3000 K

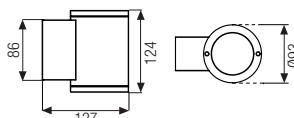

9071 - 9072 Ø 93



Monodirezionale
Mono direction light

9071.66X	LED	4W	510 lm	4000 K
9071.67X	LED	4W	500 lm	3000 K
● 9071.05X	LED GU10	4,9W	560 lm	4000 K
● 9071.06X	LED GU10	4,9W	560 lm	3000 K



Bidirezionale
Double direction light

9072.66X	LED	2x4W	2x510 lm	4000K
9072.67X	LED	2x4W	2x500 lm	3000K
● 9072.05X	LED GU10	2x4,9W	2x560 lm	4000K
● 9072.06X	LED GU10	2x4,9W	2x560 lm	3000K

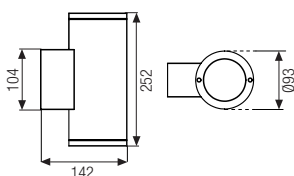

9077 Ø 93
a soffitto/ceiling mounting



Monodirezionale
Mono direction light

9077.66X	LED	4W	510 lm	4000 K
9077.67X	LED	4W	500 lm	3000 K
● 9077.05X	LED GU10	4,9W	560 lm	4000 K
● 9077.06X	LED GU10	4,9W	560 lm	3000 K

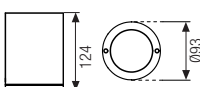

- L'apparecchio viene fornito completo di lampadina
Bulb enclosed with the luminaire

BLITZ Ø130

BLITZ Ø130



9061 Ø 130



Monodirezionale Mono direction light

- **9061.05X** **LED PAR30 E27** 9,5W 800 lm 4000 K 40°
- **9061.06X** **LED PAR30 E27** 9,5W 800 lm 3000 K 40°

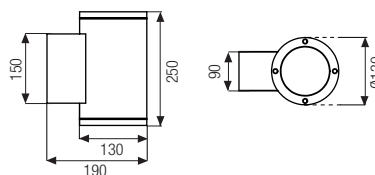

9062 Ø 130



Bidirezionale Double direction light

- **9062.05X** **LED PAR30 E27** 2x9,5W 2x800 lm 4000 K 40°
- **9062.06X** **LED PAR30 E27** 2x9,5W 2x800 lm 3000 K 40°

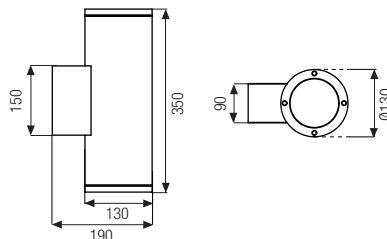

9067 Ø 130
a soffitto/ceiling mounting



Monodirezionale Mono direction light

- **9067.05X** **LED PAR30 E27** 9,5W 800 lm 4000 K 40°
- **9067.06X** **LED PAR30 E27** 9,5W 800 lm 3000 K 40°
- **9067.45X** **LED** 17,6W 2270 lm 4000 K
- **9067.46X** **LED** 17,6W 2125 lm 3000 K

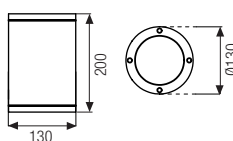

- L'apparecchio viene fornito completo di lampadina
Bulb enclosed with the luminaire

BLITZ Ø130 LED è disponibile in varie ottiche : 16°, 40°, 74°.

BLITZ Ø130 LED is available in various optics : 16°, 40°, 74°.

BLITZ Ø130 LED dispone di circuiti LED basculanti ± 15°.

BLITZ Ø130 LED provided with tiltable ± 15° LED modules.



9068 Ø 130



Bidirezionale
Double direction light

9068.66.16X	LED COB	2x15,6W	2x2620 lm	4000 K	16°
9068.67.16X	LED COB	2x15,6W	2x2520 lm	3000 K	16°
9068.66.40X	LED COB	2x15,6W	2x2620 lm	4000 K	40°
9068.67.40X	LED COB	2x15,6W	2x2520 lm	3000 K	40°
9068.66.74X	LED COB	2x15,6W	2x2620 lm	4000 K	74°
9068.67.74X	LED COB	2x15,6W	2x2520 lm	3000 K	74°

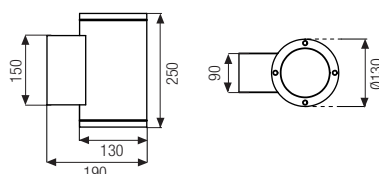

9069 Ø 130



Monodirezionale
Mono direction light

9069.66.16X	LED COB	15,6W	2620 lm	4000 K	16°
9069.67.16X	LED COB	15,6W	2520 lm	3000 K	16°
9069.66.40X	LED COB	15,6W	2620 lm	4000 K	40°
9069.67.40X	LED COB	15,6W	2520 lm	3000 K	40°
9069.66.74X	LED COB	15,6W	2620 lm	4000 K	74°
9069.67.74X	LED COB	15,6W	2520 lm	3000 K	74°

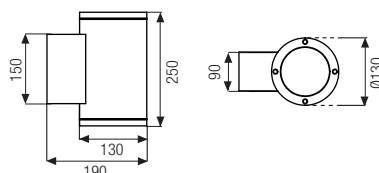

BLITZ Ø130 LED Cod. 9061 - 9064 : illuminazione a fascio largo.

BLITZ Ø130 LED Cod. 9061 - 9064 : wide beam.



9061 - 9064 LED Ø 130



Bidirezionale
Double direction light

9064.45X	LED	2x17,6W	2x2270 lm	4000 K
9064.46X	LED	2x17,6W	2x2125 lm	3000 K



Monodirezionale
Mono direction light

9061.45X	LED	17,6W	2270 lm	4000 K
9061.46X	LED	17,6W	2125 lm	3000 K

